

# SSAFH4/SSAFH6/SSAFH8

## Airfoil Blade Sunshade Horizontally Mounted



### APPLICATION

The SSAFH is a horizontally mounted sunshade featuring a 4", 6" or 8" airfoil shaped blade to provide optimal shading, promoting lower energy costs and cutting down on window glare.

### STANDARD CONSTRUCTION

<b>Blade</b>	6063T6 extruded aluminum, .125" (3.18) nominal thickness. SSAFH4 - 4" (102) airfoil blade, approximately 4" (102) center to center spacing. SSAFH6 - 6" (152) airfoil blade, approximately 6" (152) center to center spacing. SSAFH8 - 8" (203) airfoil blade approximately 8" (203) center to center spacing.
<b>Outriggers</b>	Straight Flat Bar, 0.25 5052-H32 Sheet Aluminum.
<b>Fascia</b>	Rectangle Tube, 6063-T6 extruded aluminum, .125" nominal thickness.
<b>Installation</b>	Installation brackets and hardware by others.
<b>Construction</b>	Mechanically fastened.
<b>Finish</b>	Mill.
<b>Minimum Size</b>	12"w x 12"h (305 x 305).
<b>Maximum Section Size</b>	Unlimited width x 120" (3048). Maximum Single Section is 120" x 60" (3048 x 1524).
<b>Standard Design</b>	30PSF Windload, 25PSF Snowload.
<b>Overall</b>	Single sections may be joined together in the field for unlimited overall size. Field assembly and supporting structure are by others.



"The Ruskin Sun Control products provide the optimal shading to promote lower energy costs and to cut down the glare on your buildings. Whether vertical or horizontally mounted, Ruskin can provide the optimal shading product for your needs."

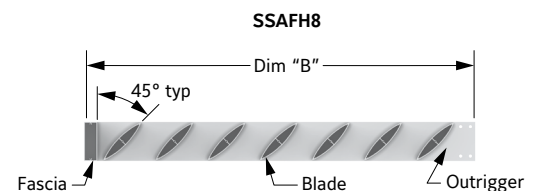
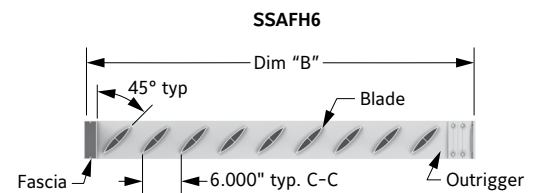
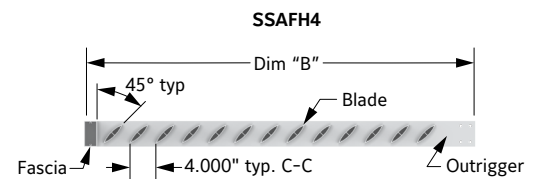

### VARIATIONS

- ▶ Alternate blade spacing
- ▶ Outrigger Options: tapered bar, channel, square tube & rectangular tube
- ▶ Fascia Options: channel, round tube, square tube & Bull Nose
- ▶ Miter corners installation brackets and hardware are available. Please consult Ruskin for available designs
- ▶ Optional finishes available at additional cost. Please see [Paint Finishes and Color Guide](#) and [Finish Type Model Chart](#) for more details. Contact [louversales@ruskin.com](mailto:louversales@ruskin.com) with questions.

All Variations are available at additional cost.

Sunshade design is highly customizable. Consult Ruskin for availability.

NOTE: Dimensions shown in parenthesis ( ) indicate millimeters.

# OUTRIGGER AND FASCIA OPTIONS

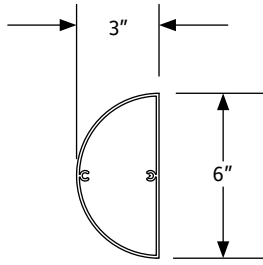

Bull nose Fascia

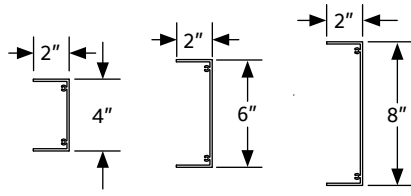

Channel Fascia

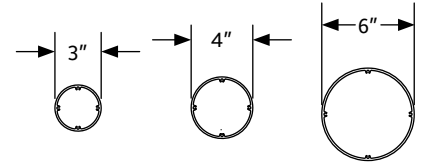

Round Fascia

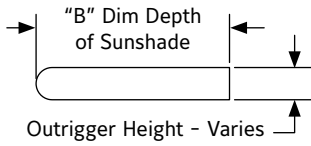

Rounded End Outrigger

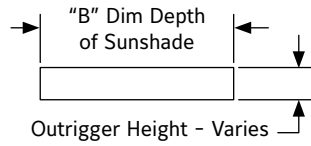

Straight Outrigger

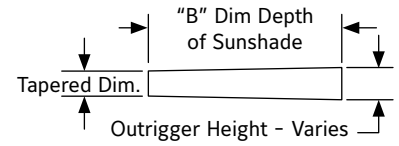

Tapered Outrigger

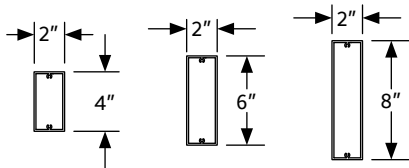

Tube Fascia

## LINKS TO IMPORTANT DOCUMENTS

### Document Title

Limited Warranty Document



3900 Doctor Greaves Road  
Grandview, MO 64030  
Website: [www.ruskin.com](http://www.ruskin.com)  
Phone: (816) 761-7476