

ELF30V

Stationary Louver

Extruded Aluminum



APPLICATION

The ELF30V is a 3" stationary louver with a 45 degree blade angle. It has sightproof chevron blades which provide privacy, conceal equipment, prevent vandalism, and act as a safety barrier to dangerous areas. This model is corrosion resistant with aluminum construction and outstanding durability and low maintenance.

STANDARD CONSTRUCTION

Frame	6063T6 extruded aluminum with .080" (2.03) nominal wall thickness. Caulking slots provided
Blades	6063T6 extruded aluminum with .080" (2.03) nominal wall thickness. Chevron blades are spaced approximately 1 7/16" (35.5) center to center
Screen	3/4" x .051" (19 x 1.3) expanded, flattened aluminum bird screen. Screen adds approximately 1/2" (13) to louver depth
Finish	Mill
Minimum Size	12"w x 12"h (305 x 305)
Maximum Size	60" x 90" (1524 x 2286)

FEATURES

- ▶ 56% Free Area
- ▶ Corrosion resistant, all aluminum construction
- ▶ Outstanding durability and low maintenance
- ▶ Sightproof chevron blades which provide privacy, conceal equipment, prevent vandalism, and act as a safety barrier to dangerous areas

VARIATIONS

Variations to the basic design of this louver are available at additional cost. They include:

- ▶ Extended sill
 - ▶ Flanged frame
 - ▶ Hinged frame
 - ▶ Front or rear security bars
 - ▶ Filter racks
 - ▶ Glazing Frame
 - ▶ Blankoff Panel
 - ▶ A variety of bird and insect screens
 - ▶ Optional finishes available at additional cost.
- Please see [Paint Finishes and Color Guide](#) and [Finish Type Model Chart](#) for more details. Contact louversales@ruskin.com with questions

Consult Ruskin for other special requirements.

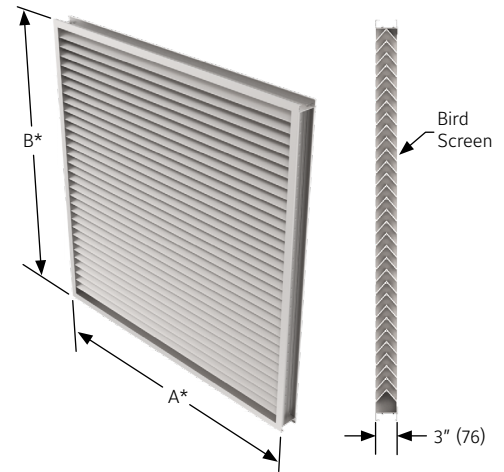

FRAME CONSTRUCTION

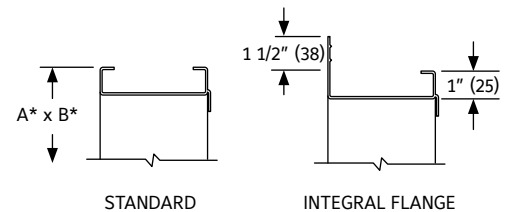

NOTES:

- Dimensions in parenthesis () indicate millimeters.
- *Units furnished 1/4" (6) smaller than given opening dimensions.

FREE AREA GUIDE

Free Area Guide shows free area in ft² and m² for various sizes of ELF30V.

Width – Inches and Meters

HEIGHT	12	18	24	30	36	42	48	54	60	66	72	78	84	90
0.30	0.30	0.45	0.60	0.75	0.90	1.05	1.20	1.35	1.50	1.65	1.80	1.95	2.10	2.25
12 0.30	0.32 0.03	0.52 0.05	0.71 0.07	0.9 0.08	1.1 0.10	1.29 0.12	1.49 0.14	1.68 0.16	1.87 0.17	2.07 0.19	2.26 0.21	2.46 0.23	2.65 0.25	2.85 0.27
18 0.45	0.58 0.05	0.93 0.09	1.28 0.12	1.63 0.15	1.98 0.18	2.33 0.22	2.68 0.25	3.03 0.28	3.37 0.31	3.72 0.35	4.07 0.38	4.42 0.41	4.77 0.44	5.12 0.48
24 0.60	0.9 0.08	1.44 0.13	1.99 0.19	2.53 0.24	3.08 0.29	3.62 0.34	4.16 0.39	4.71 0.44	5.25 0.49	5.79 0.54	6.34 0.59	6.88 0.64	7.42 0.69	7.97 0.74
30 0.75	1.16 0.10	1.86 0.16	2.56 0.22	3.25 0.27	3.95 0.33	4.65 0.39	5.35 0.45	6.05 0.51	6.75 0.57	7.45 0.63	8.15 0.68	8.85 0.74	9.55 0.80	10.24 0.86
36 0.90	1.41 0.13	2.27 0.21	3.12 0.29	3.98 0.37	4.83 0.45	5.69 0.53	6.54 0.61	7.4 0.69	8.25 0.77	9.1 0.85	9.96 0.93	10.81 1.01	11.67 1.09	12.52 1.16
42 1.05	1.67 0.16	2.68 0.25	3.69 0.34	4.7 0.44	5.71 0.53	6.72 0.62	7.73 0.72	8.74 0.81	9.75 0.91	10.76 1.00	11.77 1.09	12.78 1.19	13.79 1.28	14.8 1.38
48 1.20	1.93 0.18	3.09 0.29	4.26 0.40	5.42 0.50	6.59 0.61	7.75 0.72	8.92 0.83	10.08 0.94	11.25 1.05	12.41 1.15	13.58 1.26	14.74 1.37	15.91 1.48	17.07 1.59
54 1.35	2.19 0.20	3.51 0.33	4.83 0.45	6.15 0.57	7.47 0.69	8.79 0.82	10.11 0.94	11.43 1.06	12.75 1.19	14.07 1.31	15.39 1.43	16.71 1.55	18.03 1.68	19.35 1.80
60 1.50	2.51 0.23	4.02 0.37	5.54 0.52	7.05 0.66	8.57 0.80	10.08 0.94	11.6 1.08	13.11 1.22	14.62 1.36	16.14 1.50	17.65 1.64	19.17 1.78	20.68 1.92	22.2 2.06
66 1.65	2.77 0.26	4.44 0.41	6.11 0.57	7.78 0.72	9.44 0.88	11.11 1.03	12.78 1.19	14.45 1.34	16.12 1.50					
72 1.80	3.02 0.28	4.85 0.45	6.67 0.62	8.5 0.79	10.32 0.96	12.15 1.13	13.97 1.30	15.8 1.47	17.62 1.64					
78 1.95	3.28 0.31	5.26 0.49	7.24 0.67	9.22 0.86	11.2 1.04	13.18 1.23	15.16 1.41	17.14 1.59	19.12 1.78					
84 2.10	3.54 0.33	5.67 0.53	7.81 0.73	9.94 0.92	12.08 1.12	14.22 1.32	16.35 1.52	18.49 1.72	20.62 1.92					
90 2.25	3.79 0.35	6.09 0.57	8.38 0.78	10.67 0.99	12.96 1.21	15.25 1.42	17.54 1.63	19.83 1.84	22.12 2.06					

TYPICAL INSTALLATION DETAILS

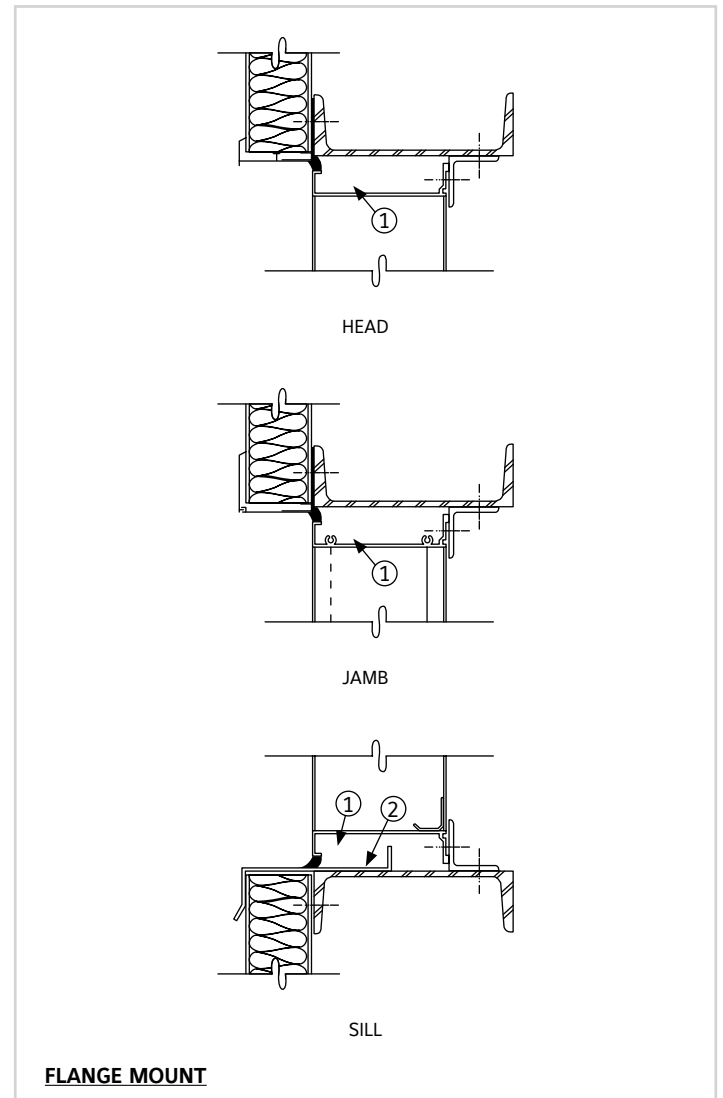
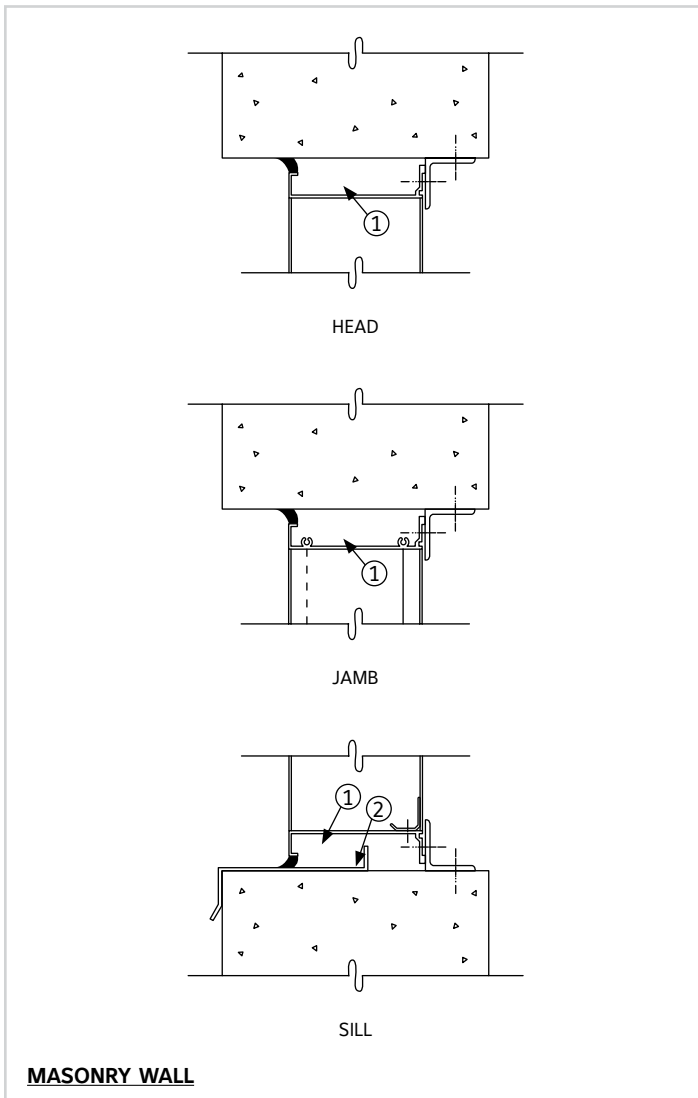

Clip angles ① and extended sill ② available at extra charge.

SUGGESTED SPECIFICATION

Furnish and install louvers as hereinafter specified where shown on plans or as described in schedules. Louvers shall be "Stationary" type entirely contained within a 3" (76) frame. Louver components (heads, jambs, sills, blades & mullions) shall be factory assembled by the louver manufacturer. Louver design shall incorporate structural supports required to withstand a wind load of 30 PSF (1.44kPa) / 110 MPH (177kph) - specifier may substitute any loading required).

Louvers shall be Ruskin Model ELF30V extruded 6063T6 aluminum alloy construction as follows:

Frame: .080" (2.0) wall thickness.

Blades: .080" (2.0) wall thickness chevron blades on approximately 1 7/16" (35.5) centers.

Screen: 3/4" x .051" (19 x 1.3) expanded, flattened aluminum in removable frame.

i LINKS TO IMPORTANT DOCUMENTS

Document Title

Paint Finishes and Color Guide

Limited Warranty Document



3900 Doctor Greaves Road
Grandview, MO 64030
Website: www.ruskin.com
Phone: (816) 761-7476